

ELLA Extractor

Extractor for SX-ELLA Esophageal Stents

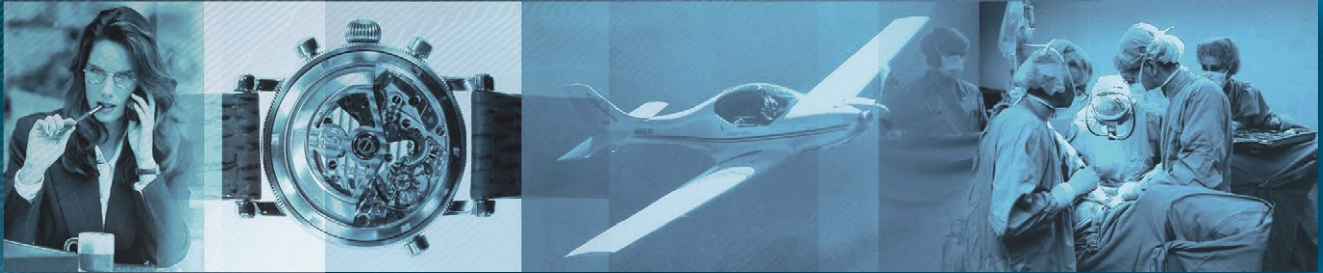

ELLA Extractor



Simple and reliable removal system

Atraumatic stent retrieval

Allows removal of migrated stents from stomach

Radiopaque markers

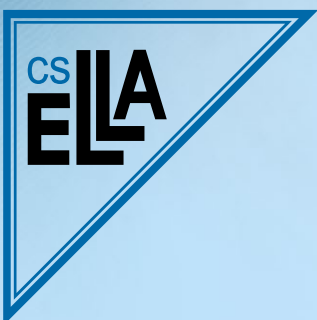

Basic description

Extractor for SX-ELLA Esophageal Stents - ELLA Extractor

ELLA Extractor is designed for extraction of SX-ELLA esophageal stents:

- SX-ELLA Stent Esophageal - Flexella
- SX-ELLA Stent Esophageal - Flexella Plus
- SX-ELLA Stent Esophageal HV - HV Stent
- SX-ELLA Stent Esophageal HV - HV Stent Plus
- SX-ELLA Stent Danis - Danis Stent
- Esophageal Stent Danis Seal

Removal recommendations:

Danis Stent should be removed within maximum of 7 days following implantation, Esophageal Stent Danis Seal should be removed within maximum of 14 days following implantation / after that period using extractor is not recommended.

Removal of fully covered stents placed in benign strictures should be performed within 4 weeks after stent implantation.

In addition ELLA Extractor may be used for retrieval of both fully and partially covered stents that migrated into stomach.

Features / Benefits

- ☑ **Atraumatic stent capture** / Stent is completely retrieved into overtube prior to removal / No shearing forces on esophageal wall
- ☑ **Excellent radiopacity** / Stainless steel cable and radiopaque markers on overtube / Precise fluoroscopic control
- ☑ **Unique design** / Safe removal of stents from their original position or stents migrated into stomach
- ☑ **Through-the-scope application** / Extraction cable is designed for use through working channel of standard endoscope (2.8 mm) / Retrieval loop of stent is captured with arresting hook under direct vision

Additional description

9.4 mm (28 F) / 100 cm overtube with distal radiopaque marker
2.6 mm / 150 cm stainless steel extraction cable consisting of central wire with arresting hook and braided sheath

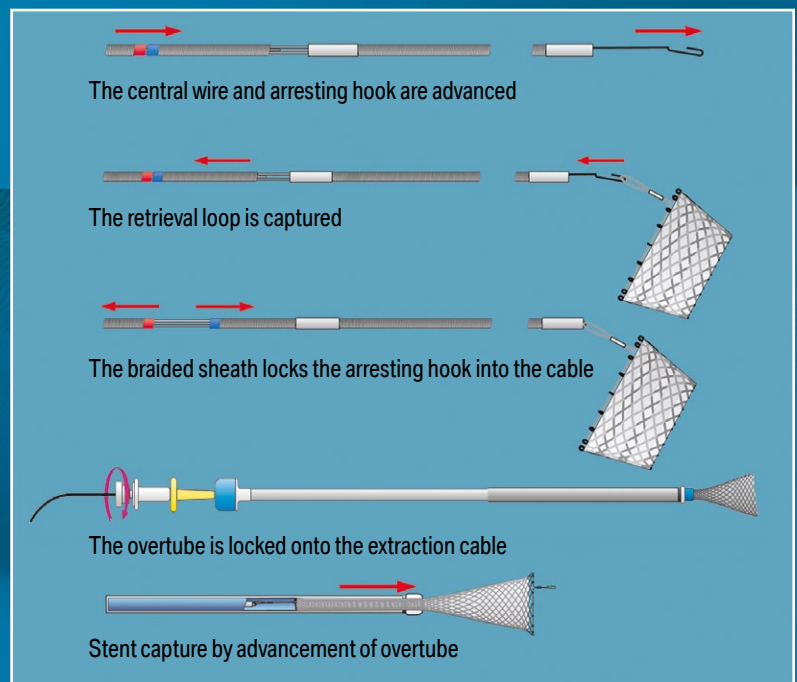
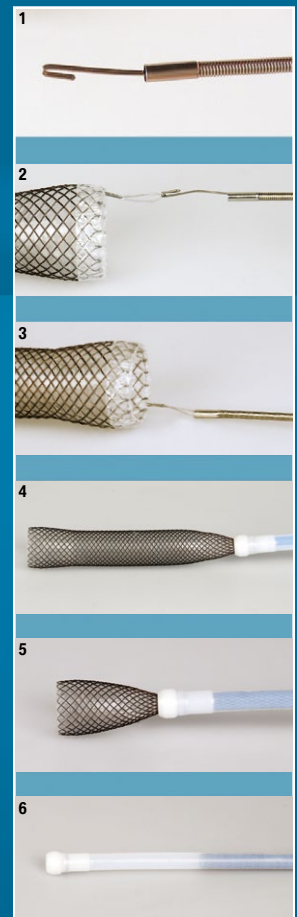
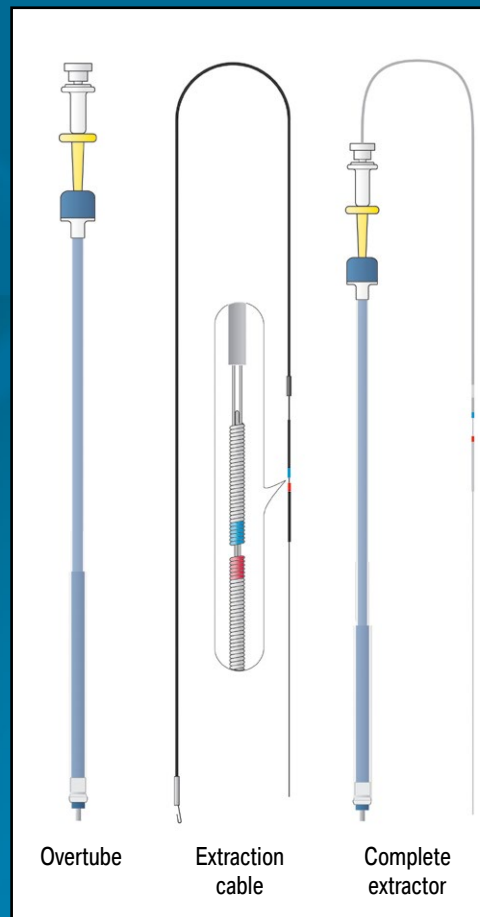

Available sizes

REF No.	Extraction cable		Overtube	
	Outer diameter [mm]	Length [cm]	Length [cm]	Outer diameter [F]
015-01-28-1000	2.6	150	100	28

Distributor:

Manufacturer:

ELLA-CS, s.r.o.

Milady Horakove 504/45, Trebes
500 06 Hradec Kralove, Czech Republic

Tel.: +420 495 279 111 Fax: +420 495 265 655
E-mail: info@ellacs.eu URL: www.ellacs.eu